



000316 Conference Rooms

TYPICAL BUILDING SPACES

1 General

Conference rooms are general use spaces designed to support a large number of meeting attendees. Room sizes needs to be verified with the CWU project manager, but CWU typically relies on the following conference room sizes:

- Small = up to 12 people
- Large = between 20-24 attendees with layouts to support multi configurations.

Conference rooms shall have high performance standards for acoustics, AV and IT equipment, and lighting. Large conference rooms should accommodate space for built-in casework.

2 Sample Layout

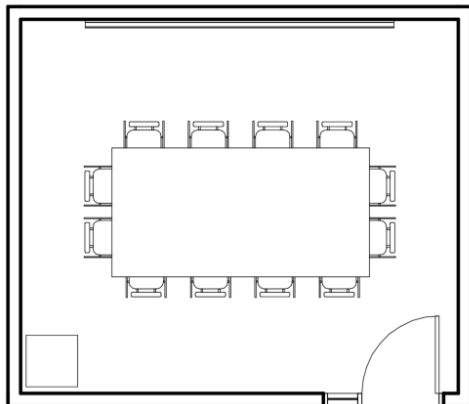

SMALL

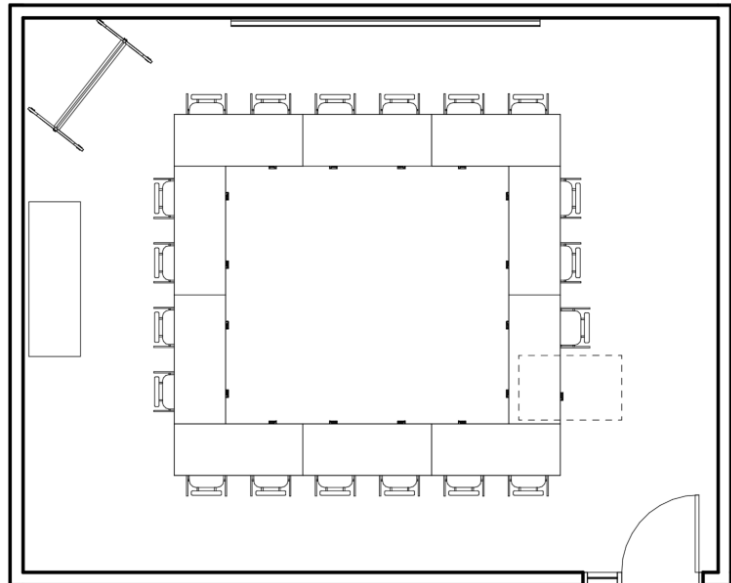

LARGE



3 Detailed Space Requirements

ARCHITECTURAL	MECHANICAL	FIXED EQUIPMENT
Floor	Temperature	Lectern / Podium
Carpet ●	68°-75° ± 2°F	Casework ●
Concrete (sealed)	Other ●	Marker Board ●
Porcelain Tile	Humidity	Tack Board ●
Resilient	Controlled	Smart Board ●
other	Uncontrolled ●	Projection Screen ●
		Lockers
Base	other	Wall-Mounted Shelving
None		Compressed Gas Storage
Resilient ●		Shower Curtain
Wood		
Tile		
other		
	PLUMBING	
Walls	Compressed Air, 100 psi (A)	
GWB, Metal Studs	Vacuum	
Paint	Floor Drain (FD)	
Wainscot (54" FRP)	Potable hot/cold water	other
Tile	Sink (Mop Sink)	
Mold-Resistant GWB	Toilet	
	Shower	
	other	
		FURNISHINGS
Ceiling		Tables ●
Open ●	ELECTRICAL	Chairs ●
Acoustic Ceiling Panel	110V, 20A, 1 Phase ●	Instructor's Chair
Gypsum Board, Paint	208V, 30A, 1 Phase	Computer ●
Height	Floor Boxes	Printer
	Lighting Level	Office Workstation
Doors	Manual Dimming	Bookcase
Door Material WD	Occupancy Sensors	File Cabinets
Frame Material HM	other	Open Shelving (Freestanding)
3'-0" x 7'-0" ●		Fixed Height Demo Table
3'-6" x 7'-0"		Adjust. Height Demo Table
6'-0" x 7'-0"		Copier
1 Access Control ●	TELECOM / AUDIO VISUAL	Biowaste Disposal
	Data/Telecom Outlet ●	Sharps Container
Windows	Projector ●	Refrigerator
Interior Relight ●	Audio ●	Microwave
Daylight	Other	Clocks ●
Roll Down Shades ●	other	
Black Out Shades		other

REMARKS:

1. Only when located for general use outside of department or administrative areas.