



000315 Instructional Spaces – Computer Classrooms

TYPICAL BUILDING SPACES

1 General

Instructional Spaces that are specifically used for computer classrooms shall be sized for 36 seats with at least one aisle to provide passage between the rows of workstations. Each computer tables shall be 24 inches by 60 inches with at least one height adjustable table for ADA accessible workstation. Power outlets shall be installed on walls to avoid having floor outlets.

2 Sample Layout

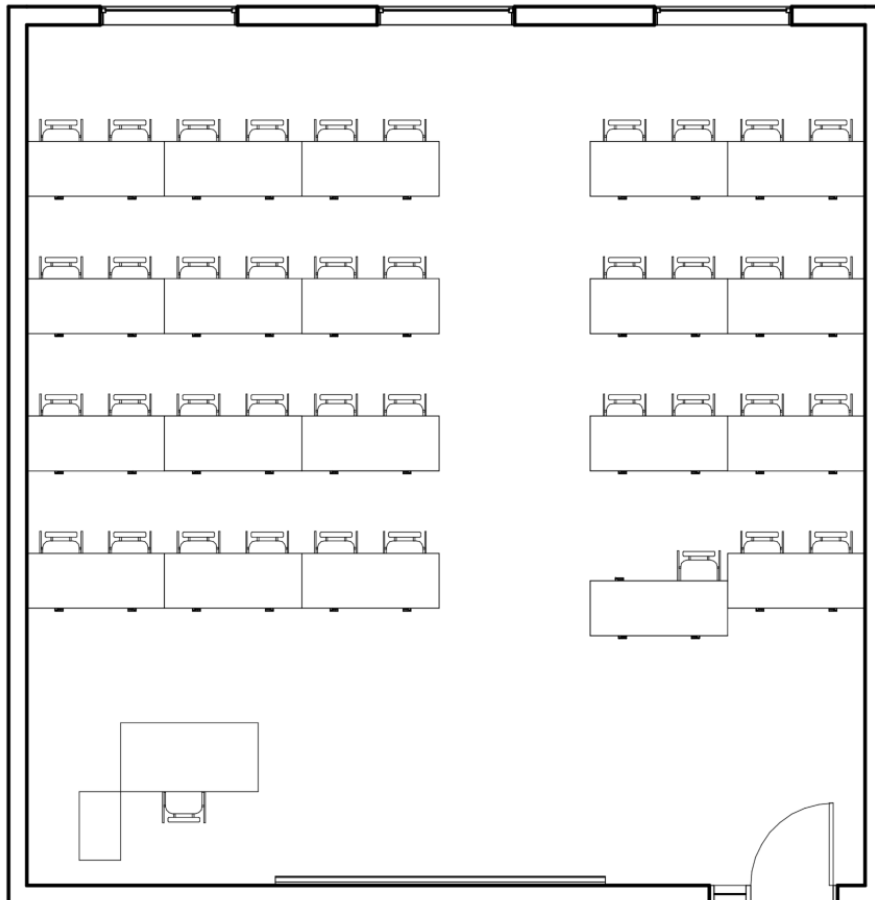



3 Detailed Space Requirements

ARCHITECTURAL	MECHANICAL	FIXED EQUIPMENT
Floor	Temperature	Lectern / Podium
Carpet	68°-75° ± 2°F	Casework
Concrete (sealed)	Other	Marker Board
Porcelain Tile	Humidity	Tack Board
Resilient	Controlled	Smart Board
other	Uncontrolled	Projection Screen
		Lockers
Base	other	Wall-Mounted Shelving
None		Compressed Gas Storage
Resilient		Shower Curtain
Wood		
Tile		
other		
	PLUMBING	
Walls	Compressed Air, 100 psi (A)	
GWB, Metal Studs	Vacuum	
Paint	Floor Drain (FD)	
Wainscot	Potable hot/cold water	other
Tile	Sink (Mop Sink)	
Mold-Resistant GWB	Toilet	
	Shower	
	other	
		FURNISHINGS
Ceiling		Tables
Open		Chairs
Acoustic Ceiling Panel	ELECTRICAL	Instructor's Chair
Gypsum Board, Paint	110V, 20A, 1 Phase	Computer
Height	208V, 30A, 1 Phase	Printer
	Floor Boxes	Office Workstation
	Lighting Level	Bookcase
Doors	Manual Dimming	File Cabinets
Door Material	Occupancy Sensors	Open Shelving (Freestanding)
Frame Material	other	Fixed Height Demo Table
3'-0" x 7'-0"		Adjust. Height Demo Table
3'-6" x 7'-0"		Copier
6'-0" x 7'-0"		Biowaste Disposal
Access Control		Sharps Container
		Refrigerator
	TELECOM / AUDIO VISUAL	Microwave
Windows	Data/Telecom Outlet	Clocks
Interior Relight	Projector	
Daylight	Audio	
Roll Down Shades	Other	
Black Out Shades	other	other

REMARKS: