



000307 Recycling and Waste Collection

TYPICAL BUILDING SPACES

1 General

Recycling and Waste collection areas are generally stored outside of the buildings and are screened from view. Exterior and interior locations shall be provided in all new construction and renovation, and it shall be adjacent to the building's service/maintenance entrance or, if applicable, the building loading dock. CWU typically uses 96-gallon wheeled collection bins and will require space for at least three bins per building depending on program needs and frequency of collection.

1. Outdoor Services Area

- a. Waste/recycling operations and vehicular accessibility/maneuverability must be considered. Schematic design plans must diagram these considerations.
- b. Provide all weather access sheltered from wind and easily accessible by custodial staff. Screen collection site with materials compatible with adjacent structures.
- c. Protect walls around waste containers from damage caused by less-than-careful opening of lids.
- d. Bins in service areas shall be easily accessible from building interior from at-grade or by ramps.
- e. Provide a hose bib and drainage at all service areas.
- f. Provide lighting to illuminate the area to a level that provides safety and security.

2. Indoor Waste and Recycling

- a. Provide 100 sf (10' x10') central recycling room per facility for consolidation of paper and cardboard, preferred location is near the loading/unloading area or service entrance. Must be able to accommodate 96-gallon containers, 1-yd tilt trucks and dollies.
- b. Provide recycling/waste stations, minimum one per floor and one per main entrance.
- c. Recycling/waste stations can built-in or pre-manufactured cabinet. Cabinets should have 3 30-gallon sections: garbage, paper, bottles/cans. These sections need to be able to change verbiage.

2 Sample Layout

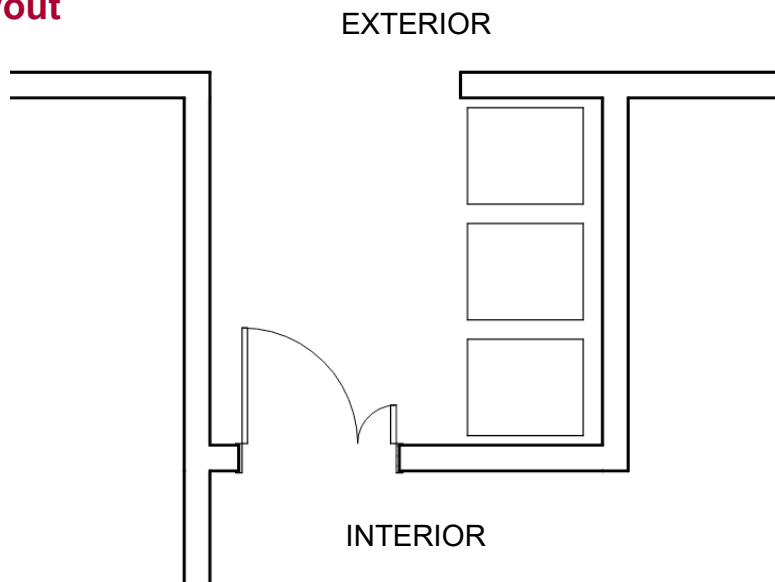



3 Detailed Space Requirements

ARCHITECTURAL	MECHANICAL	FIXED EQUIPMENT
Floor	Temperature	Lectern / Podium
Carpet	68°-75° ± 2°F	Casework
Concrete (sealed) ●	Other	Marker Board
Porcelain Tile	Humidity	Tack Board
Resilient	Controlled	Smart Board
other	Uncontrolled	Projection Screen
		Lockers
Base	other	Wall-Mounted Shelving
None		Compressed Gas Storage
Resilient		Shower Curtain
Wood		
Tile		
other		
	PLUMBING	
Walls	Compressed Air, 100 psi (A)	
GWB, Metal Studs	Vacuum	
Paint	Floor Drain (FD) ●	
Wainscot	Floor Drain (FD)	other
Tile	Potable hot/cold water	
Mold-Resistant GWB	Sink	
	Toilet	
	Shower	
	Hose Bib ●	
		FURNISHINGS
Ceiling	ELECTRICAL	Tables
Open	110V, 20A, 1 Phase	Chairs
Acoustic Ceiling Panel	208V, 30A, 1 Phase	Instructor's Chair
Gypsum Board, Paint	Floor Boxes	Computer
Height	Lighting Level	Printer
	Manual Dimming	Office Workstation
Doors	Occupancy Sensors	Bookcase
Door Material	other	File Cabinets
Frame Material		Open Shelving (Freestanding)
3'-0" x 7'-0"		Fixed Height Demo Table
3'-6" x 7'-0"		Adjust. Height Demo Table
6'-0" x 7'-0"		Copier
Access Control ●		Biowaste Disposal
	TELECOM / AUDIO VISUAL	Sharps Container
Windows	Data/Telecom Outlet	Refrigerator
Interior Relight	Projector	Microwave
Daylight	Audio	
Roll Down Shades	Other	
Black Out Shades	other	other

REMARKS: